

# Ayr Street Proposed Plan

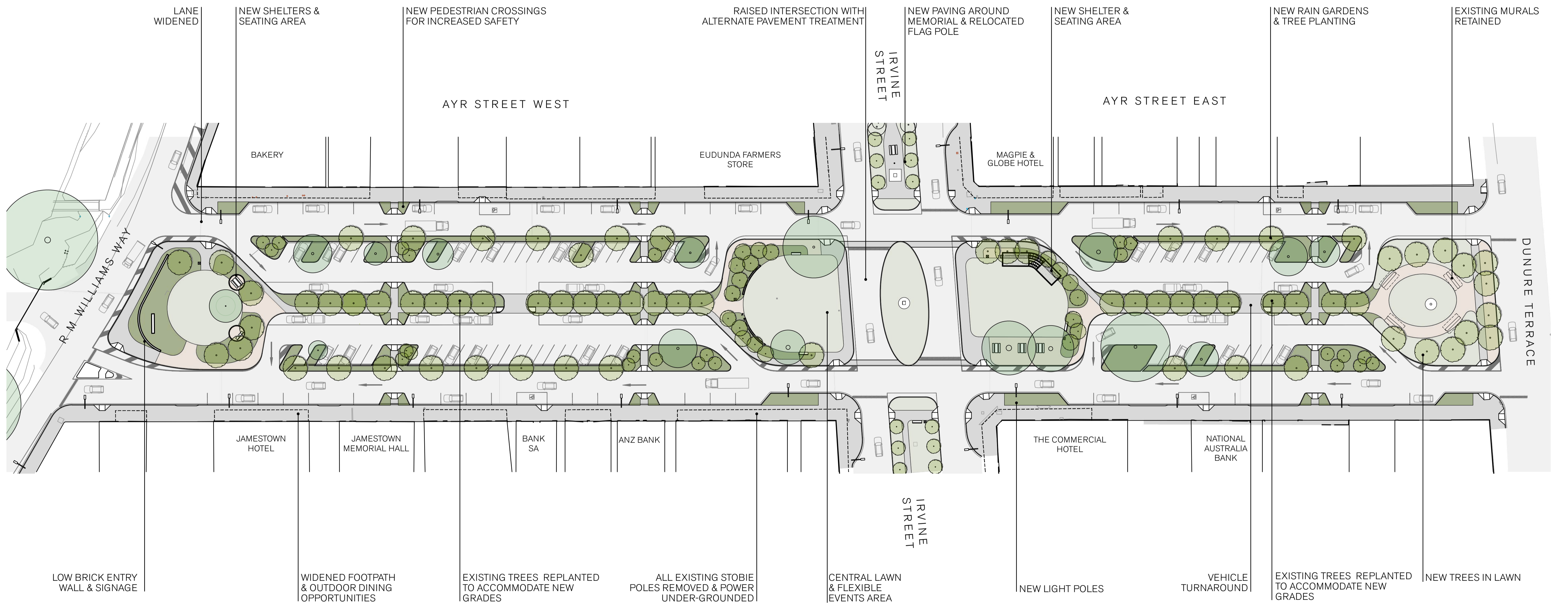

APPROXIMATELY 160 CAR PARKS  
 APPROXIMATELY 100 NEW TREES  
 MEMORIAL TREES RETAINED & REPLANTED  
 WITHIN REFURBISHED CENTRAL VERGE

- EXISTING TREE RETAINED
- PROPOSED TREE

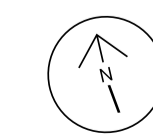

# Ayr Street Cross-sections

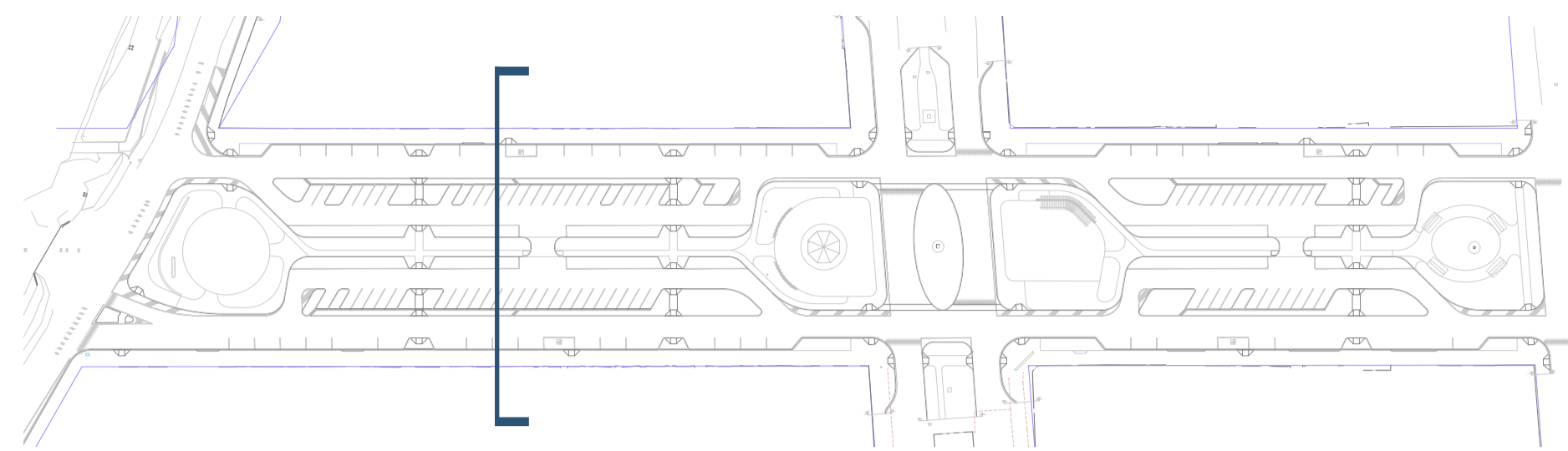

NTS

## Existing Section

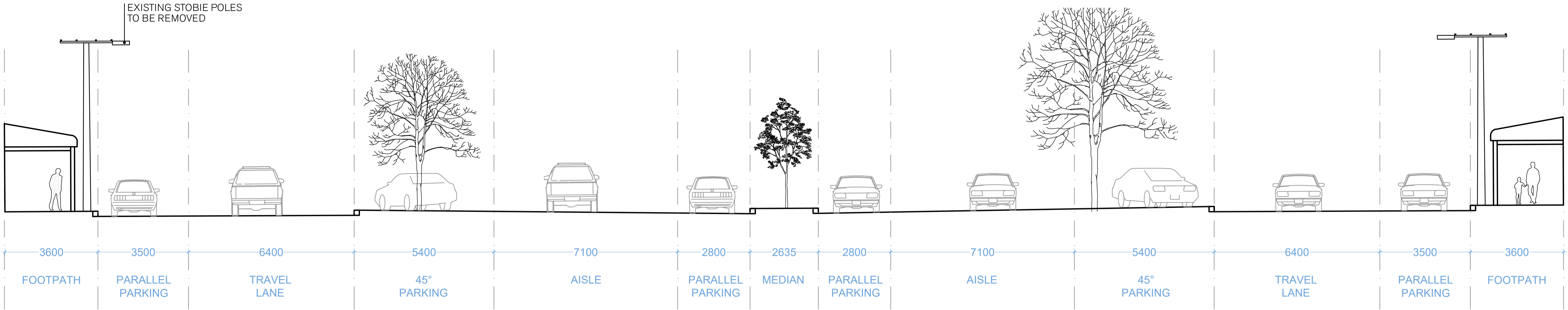

## Proposed Section

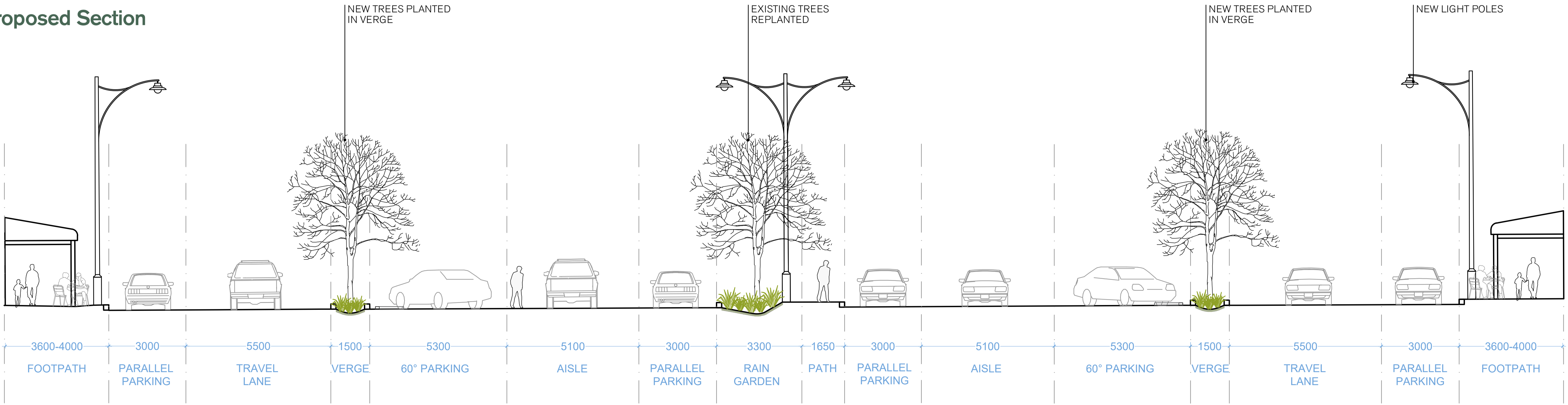

# Ayr Street Proposed Views



- 1 Flexible lawn area
- 2 Compacted sand footpath
- 3 Low brick seating wall
- 4 New shelter
- 5 Raised intersection (flush with lawn)
- 6 Relocated flag pole to Boer War memorial
- 7 New paved footpath
- 8 Replanted memorial trees



- 1 Flexible lawn area
- 2 Compacted sand footpath
- 3 Low brick seating wall
- 4 New shelter

# Ayr Street Proposed Materials

## Pavements & Surfaces



**Brick unit paving**  
Ayr Street footpaths



**Feature brick unit paving**  
Ayr Street footpaths



**Concrete unit paver**  
Raised crossover between  
Irvine Street & Ayr Street



**Concrete unit paver (permeable)**  
As required surrounding existing  
trees within car park verge



**Compacted sand**



**Swale**



**Turf**

## Elements



**Steel edge**



**Garden edging**



**Integrated pavement artwork**



**Relocated flag pole**

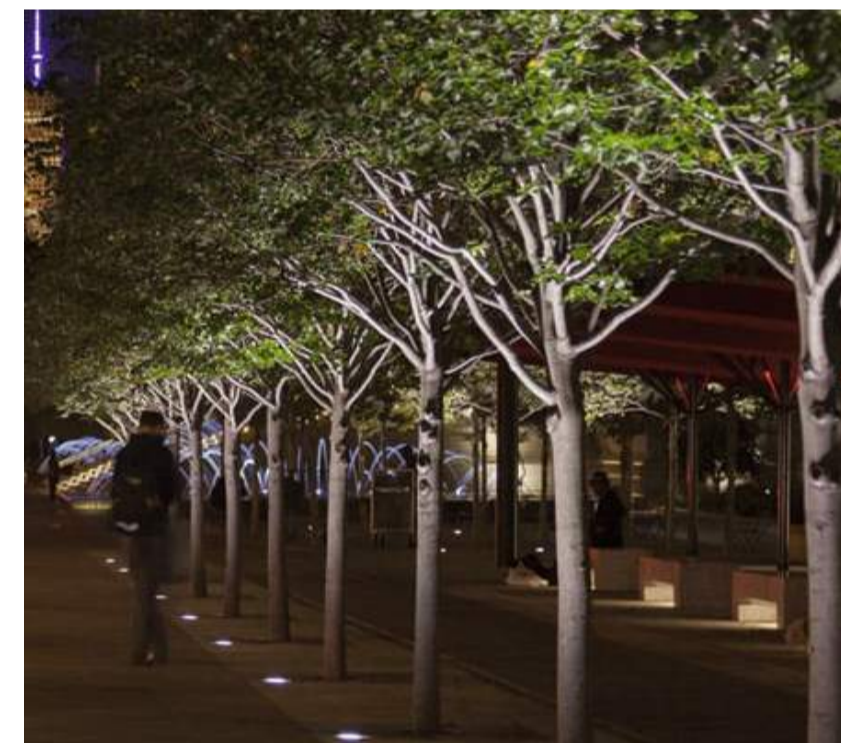

**Tree uplighting**



**Feature uplighting**



**Street lighting**

## Furniture



**Picnic bench**



**Bench seat**



**Shelter**



**Low brick seating walls**



**Drink fountain**



**Bin enclosure**



**Bike rack**

# Ayr Street Tree Transplanting

## Tree Transplanting

### Tree Transplanting

The existing centre median trees within Ayr street were donated & planted by members of the community as a memorial grove.

The proposed upgrade of Ayr Street includes removal & reinstatement of these trees to provide a safer & more functional layout for vehicles & pedestrians while also better managing stormwater.

The important status of these existing trees is recognised & as a result, they are proposed for transplanting through the construction phase.

Transplanting would include careful removal of the trees prior to construction, protection during construction & replanting following civil works.

This process would provide the opportunity to replant the trees using best practice techniques, including soil preparation & amelioration, irrigation, installation & staking.

### Proposed Methodology

Existing trees will be carefully removed to ensure the tree rootballs remain intact as much as possible & stored in fit for purpose crates. Excavation will only occur during autumn or winter when the trees are dormant.

Each tree will be tagged with its corresponding memorial information & plaques reinstated following replanting.

Existing soil will be excavated & stockpiled for re-use.

Streetscape & carpark works will then be undertaken, including installation of all kerbs, footpaths, stormwater infrastructure & surfaces.

Following civil works, the garden beds will be prepared by ripping the sub-base & ensuring there is no soil glazing to walls of tree pits. The stockpiled soil will be tested to confirm additives for amelioration prior to reinstatement of trees.

Following garden bed preparation, trees will be installed in as per landscape documentation, including tree stakes & ties.

Irrigation will be installed to all new garden beds.

### Associated Risks

Risks associated with transplanting are outlined below:

- Damage to the tree structure or rootballs during removal & reinstatement.
- Transplant shock leading to suckering & poor growth.
- Failure to establish in new location following installation.

## Existing Tree Species To Be Transplanted



**Pyrus calleryana**

Ornamental Pear



**Ulmus parvifolia**

Chinese Elm

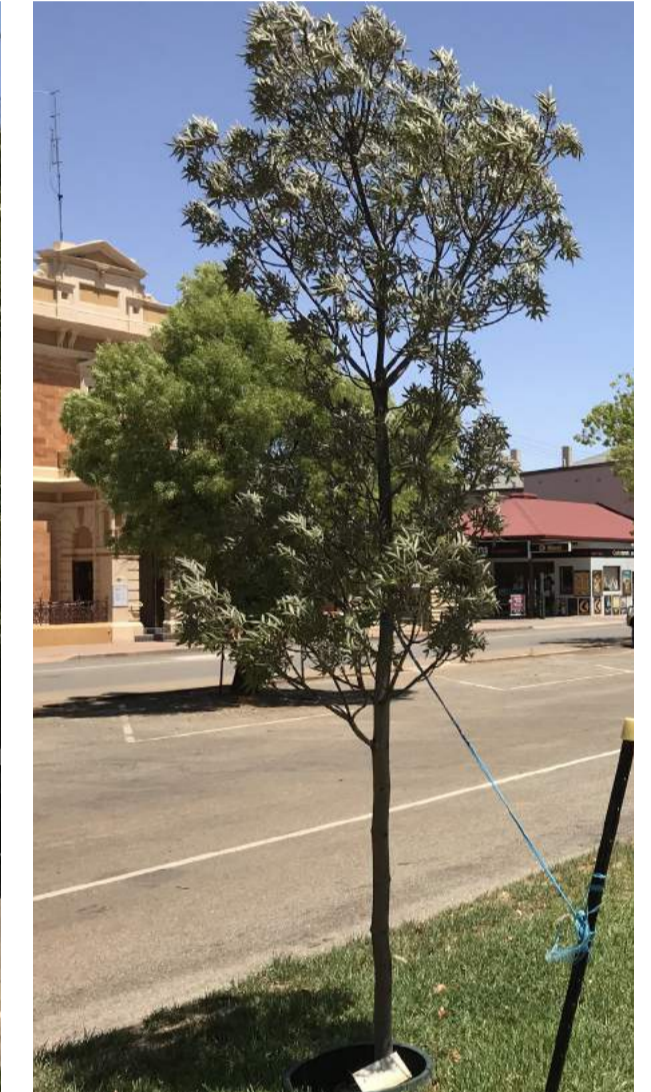

**Fraxinus**

Ash

## Existing Trees For Transplanting

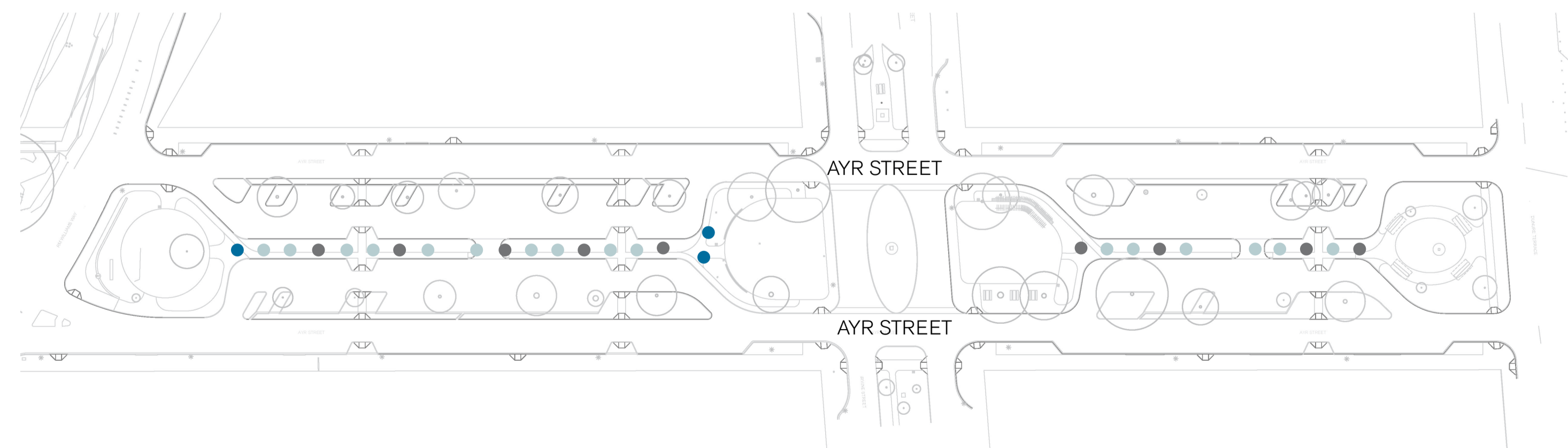

SPECIES IDENTIFIED AS PER ADELAIDE ARB CONSULTANTS ARBORISTS REPORT, DATED 18TH OF MAY 2022

## Proposed Tree Transplanting Plan

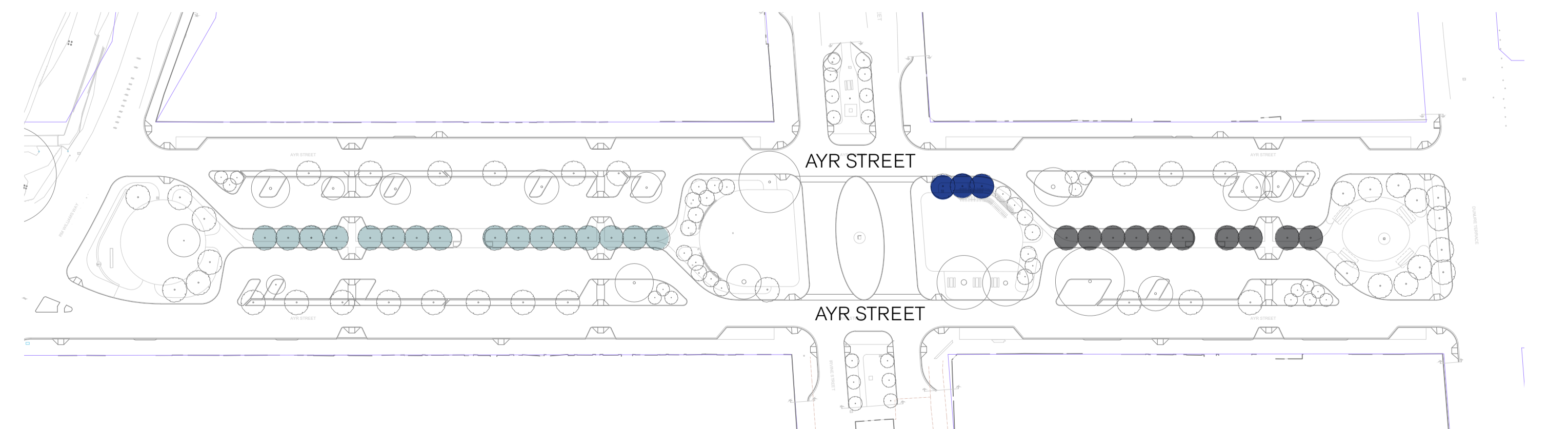

SPECIES CONSOLIDATED INTO 3 NO. LOCATIONS.



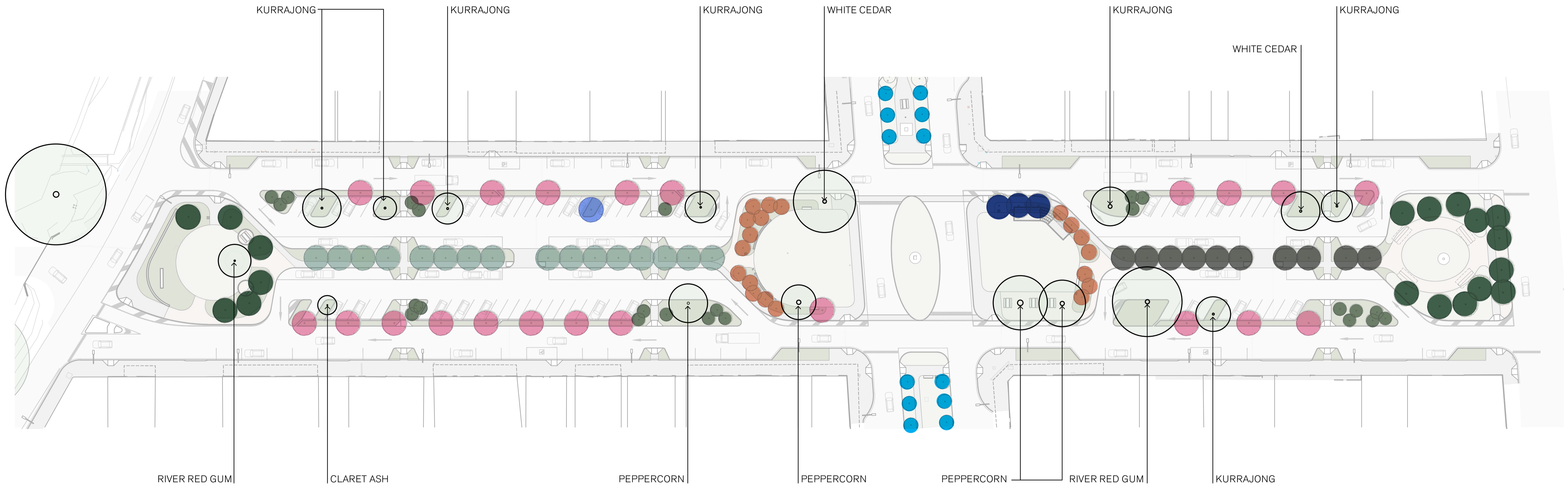







# Ayr Street Proposed Tree Plan



## Proposed Tree Species

## Existing Tree Species To Be Transplanted



										
<b>Melia azedarach 'Elite'</b>	<b>Corymbia maculata</b>	<b>Eucalyptus victrix</b>	<b>Corymbia 'Scentuous'</b>	<b>Platanus x acerifolia</b>	<b>Lagerstroemia 'Natchez'</b>	<b>Albizia julibrissin</b>	<b>Brachychiton populneus</b>	<b>Pyrus calleryana</b>	<b>Ulmus parvifolia</b>	<b>Fraxinus</b>
White Cedar 'Elite'	Spotted Gum	Coolibah, Little Ghost Gum	Dwarf Lemon Scented Gum	Plane Tree	Crepe Myrtle 'Natchez'	Persian Silk Tree	Kurrajong Tree	Ornamental Pear	Chinese Elm	Ash
H 10m W 8m	H 25m W 10m	H 12m W 8m	H 7m W 3m	H 14m W 10m	H 5m W 4m	H 5m W 4m	H 10m W 8m	H 8m W 5m	H 13m W 10m	H 8m W 5m

# Ayr Street Proposed Lighting Plan

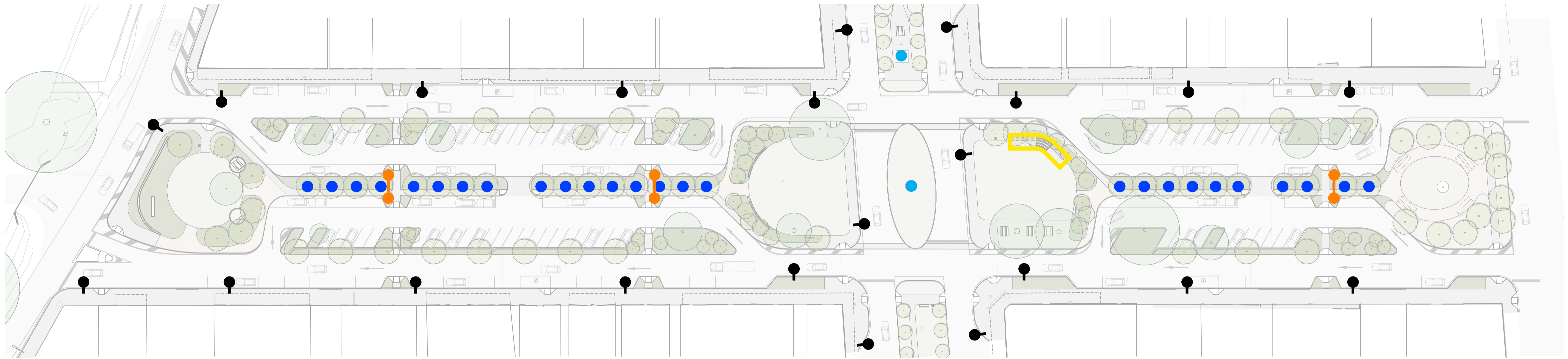

**Tree Uplighting**

Type: Amenity lighting  
Lighting Intent: Tree uplighting & directional lighting for pedestrians



**Feature Uplighting**

Type: Amenity lighting  
Lighting Intent: Memorial uplighting for Trooper Goodes Memorial & lighting for directional plinth



**Street Lighting**

Type: Compliant to Australian Standards  
Lighting Intent: Vehicle & pedestrian movement & safety standards

- New street lighting (Currently being undertaken)
- Possible additional twin outreach post top light
- Proposed memorial tree uplighting (Supports east-west pedestrian movement)
- Feature & War Memorial lighting
- Lighting to shelter



1:500 / A1 | 0 | 5 | 10 | 20 | 40m